

Nahtlose Hydraulikleitungsrohre

EN 10 305-4 E 235+N

| Bezeichnung | äußerer Durchmesser (mm) | Wanddicke (mm) | innen Durchmesser (mm) | Gewicht (kg/m) |
|-------------|-----------------------------|-------------------|---------------------------|-------------------|
| 4 x 0,5 | 4 | 0,5 | 3,0 | 0,043 |
| 6 x 1,0 | 6 | 1,0 | 4,0 | 0,123 |
| 6 x 1,5 | 6 | 1,5 | 3,0 | 0,166 |
| 6 x 2,0 | 6 | 2,0 | 2,0 | 0,197 |
| 6 x 2,25 | 6 | 2,25 | 1,5 | 0,208 |
| 7 x 1,5 | 7 | 1,5 | 4,0 | 0,203 |
| 8 x 1,0 | 8 | 1,0 | 6,0 | 0,173 |
| 8 x 1,5 | 8 | 1,5 | 5,0 | 0,240 |
| 10 x 1,0 | 10 | 1,0 | 8,0 | 0,222 |
| 10 x 1,5 | 10 | 1,5 | 7,0 | 0,314 |
| 10 x 2,0 | 10 | 2,0 | 6,0 | 0,395 |
| 10 x 2,5 | 10 | 2,5 | 5,0 | 0,462 |
| 12 x 1,0 | 12 | 1,0 | 10,0 | 0,271 |
| 12 x 1,5 | 12 | 1,5 | 9,0 | 0,388 |
| 12 x 2,0 | 12 | 2,0 | 8,0 | 0,493 |
| 14 x 1,0 | 14 | 1,0 | 12,0 | 0,321 |
| 14 x 1,5 | 14 | 1,5 | 11,0 | 0,462 |



Nahtlose kaltgezogene Hydraulikleitungsrohre gefertigt nach EN 10305-4 (DIN2391 / C + DIN 1630 +DIN 2445-2)) mit kreisrundem Querschnitt, zeichnen sich durch ihre besondere Maßgenauigkeit von Außen- und Innendurchmesser oder Wandstärke aus. Die Rohre haben eine ziehtechnische glatte Oberflächenbeschaffenheit.

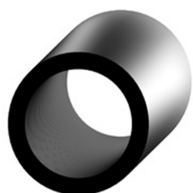

Nahtlose Hydraulikleitungsrohre

EN 10 305-4 E 235+N

| Bezeichnung | äußerer Durchmesser (mm) | Wanddicke (mm) | innen Durchmesser (mm) | Gewicht (kg/m) |
|-------------|-----------------------------|-------------------|---------------------------|-------------------|
| 14 x 2,0 | 14 | 2,0 | 10,0 | 0,592 |
| 14 x 2,5 | 14 | 2,5 | 9,0 | 0,709 |
| 15 x 1,0 | 15 | 1,0 | 13,0 | 0,345 |
| 15 x 1,5 | 15 | 1,5 | 12,0 | 0,499 |
| 15 x 2,0 | 15 | 2,0 | 11,0 | 0,641 |
| 15 x 2,5 | 15 | 2,5 | 10,0 | 0,771 |
| 15 x 3,0 | 15 | 3,0 | 9,0 | 0,888 |
| 16 x 1,0 | 16 | 1,0 | 14,0 | 0,370 |
| 16 x 1,5 | 16 | 1,5 | 13,0 | 0,536 |
| 16 x 2,0 | 16 | 2,0 | 12,0 | 0,691 |
| 16 x 2,5 | 16 | 2,5 | 11,0 | 0,832 |
| 16 x 3,0 | 16 | 3,0 | 10,0 | 0,962 |
| 18 x 1,0 | 18 | 1,0 | 16,0 | 0,419 |
| 18 x 1,5 | 18 | 1,5 | 15,0 | 0,610 |
| 18 x 2,0 | 18 | 2,0 | 14,0 | 0,789 |
| 18 x 2,5 | 18 | 2,5 | 13,0 | 0,956 |
| 18 x 3,0 | 18 | 3,0 | 12,0 | 1,110 |

Werkstoffe:

E235 (ST37.4)

E355 (ST52.4)

Sondergüten

Lieferzustand:

+N (NBK normalgeglüht)

Oberflächen:

phosphatiert

nicht phosphatiert

galvanisch verzinkt

Einsatzgebiete:

Druckgeführte Hydraulik- und

Pneumatik-Leitungssysteme

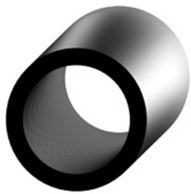

Nahtlose Hydraulikleitungsrohre

EN 10 305-4 E 235+N

| Bezeichnung | äußerer Durchmesser (mm) | Wanddicke (mm) | innen Durchmesser (mm) | Gewicht (kg/m) |
|-------------|-----------------------------|-------------------|---------------------------|-------------------|
| 20 x 1,5 | 20 | 1,5 | 17,0 | 0,684 |
| 20 x 2,0 | 20 | 2,0 | 16,0 | 0,888 |
| 20 x 2,5 | 20 | 2,5 | 15,0 | 1,079 |
| 20 x 3,0 | 20 | 3,0 | 14,0 | 1,258 |
| 20 x 4,0 | 20 | 4,0 | 12,0 | 1,578 |
| 22 x 1,0 | 22 | 1,0 | 20,0 | 0,518 |
| 22 x 1,5 | 22 | 1,5 | 19,0 | 0,758 |
| 22 x 2,0 | 22 | 2,0 | 18,0 | 0,986 |
| 22 x 2,5 | 22 | 2,5 | 17,0 | 1,202 |
| 22 x 3,0 | 22 | 3,0 | 16,0 | 1,406 |
| 22 x 3,5 | 22 | 3,5 | 15,0 | 1,597 |
| 24 x 1,0 | 24 | 1,0 | 22,0 | 0,567 |
| 24 x 2,0 | 24 | 2,0 | 20,0 | 1,085 |
| 25 x 1,5 | 25 | 1,5 | 22,0 | 0,869 |
| 25 x 2,0 | 25 | 2,0 | 21,0 | 1,134 |
| 25 x 2,5 | 25 | 2,5 | 20,0 | 1,387 |
| 25 x 3,0 | 25 | 3,0 | 19,0 | 1,628 |

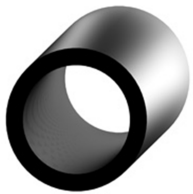

Nahtlose Hydraulikleitungsrohre

EN 10 305-4 E 235+N

| Bezeichnung | äußerer Durchmesser (mm) | Wanddicke (mm) | innen Durchmesser (mm) | Gewicht (kg/m) |
|-------------|-----------------------------|-------------------|---------------------------|-------------------|
| 25 x 4,0 | 25 | 4,0 | 17,0 | 2,072 |
| 28 x 1,5 | 28 | 1,5 | 25,0 | 0,980 |
| 28 x 2,0 | 28 | 2,0 | 24,0 | 1,282 |
| 28 x 2,5 | 28 | 2,5 | 23,0 | 1,572 |
| 28 x 3,0 | 28 | 3,0 | 22,0 | 1,850 |
| 30 x 1,5 | 30 | 1,5 | 27,0 | 1,054 |
| 30 x 2,0 | 30 | 2,0 | 26,0 | 1,381 |
| 30 x 2,5 | 30 | 2,5 | 25,0 | 1,695 |
| 30 x 3,0 | 30 | 3,0 | 24,0 | 1,998 |
| 30 x 4,0 | 30 | 4,0 | 22,0 | 2,565 |
| 32 x 2,5 | 32 | 2,5 | 27,0 | 1,819 |
| 32 x 3,0 | 32 | 3,0 | 26,0 | 2,146 |
| 35 x 2,0 | 35 | 2,0 | 31,0 | 1,628 |
| 35 x 2,5 | 35 | 2,5 | 30,0 | 2,004 |
| 35 x 3,0 | 35 | 3,0 | 29,0 | 2,367 |
| 38 x 2,5 | 38 | 2,5 | 33,0 | 2,189 |
| 38 x 3,0 | 38 | 3,0 | 32,0 | 2,589 |

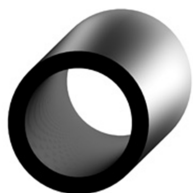

Nahtlose Hydraulikleitungsrohre

EN 10 305-4 E 235+N

| Bezeichnung | äußerer Durchmesser (mm) | Wanddicke (mm) | innen Durchmesser (mm) | Gewicht (kg/m) |
|-------------|-----------------------------|-------------------|---------------------------|-------------------|
| 38 x 4,0 | 38 | 4,0 | 30,0 | 3,354 |
| 38 x 5,0 | 38 | 5,0 | 28,0 | 4,069 |
| 42 x 2,0 | 42 | 2,0 | 38,0 | 1,973 |
| 42 x 3,0 | 42 | 3,0 | 36,0 | 2,885 |
| 42 x 5,0 | 42 | 5,0 | 32,0 | 4,562 |
| 50 x 6,0 | 50 | 6,0 | 38,0 | 6,511 |
| | | | | |
| | | | | |
| | | | | |
| | | | | |
| | | | | |
| | | | | |
| | | | | |
| | | | | |
| | | | | |
| | | | | |
| | | | | |